



Roberts Rd

Levee St

Main St

12th St

11th St

Image © 2012 GeoEye  
© 2012 Google



Google earth

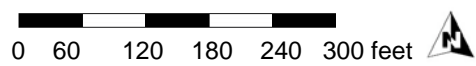
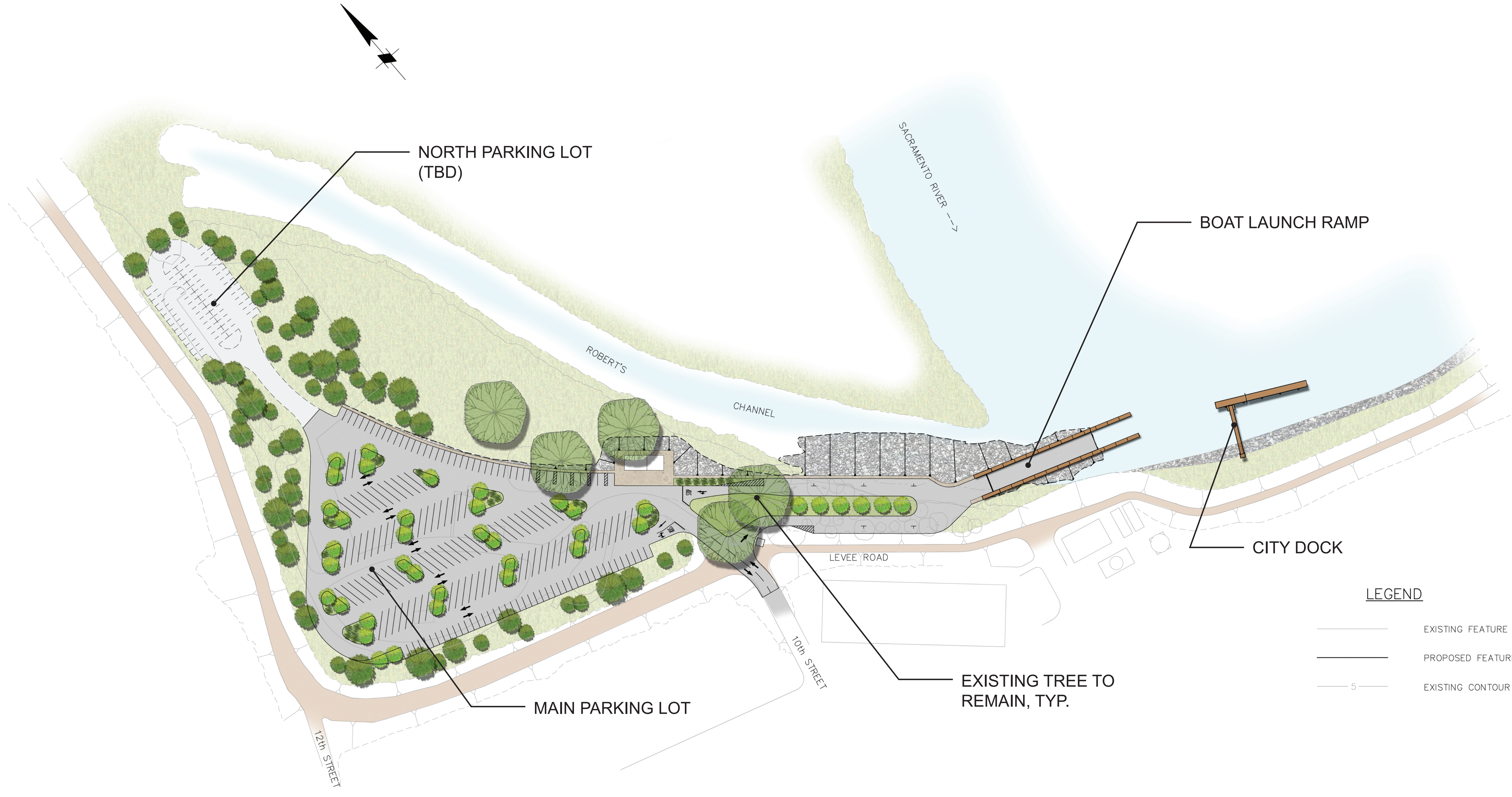

EXHIBIT - 5.2 CAMPGROUND & DAY USE MASTER PLAN  
COLUSA SACRAMENTO RIVER STATE RECREATION AREA

COLUSA SUBREACH RECREATION PLANNING

P:\7451 Colusa Boat Launch Facility\7451 CADD\DWG\745100C2.dwg Dec 01, 2011 - 1:15pm



**LEGEND**

- EXISTING FEATURE
- PROPOSED FEATURE
- 5 — EXISTING CONTOUR

**SITE PLAN**  
SCALE: 1"=80'

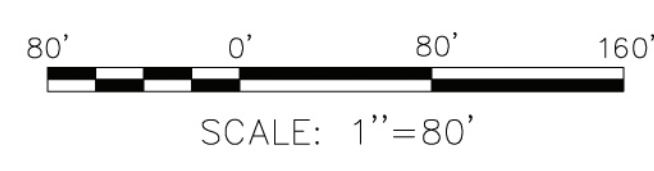

	PUBLIC WORKS	
	CITY ENGINEER	
SIGNATURE	CITY APPROVAL	DATE



**moffatt & nichol**  
2185 N. California Blvd., Suite 500  
Walnut Creek, CA 94596

DSGN	BP	DR	NN/AB	CHK
JOB NO.	7451	SUBMITTED BY	TITLE	

CITY OF COLUSA  
BOAT LAUNCHING FACILITY  
PROJECT 09-04

**SITE PLAN**

DATE 11-15-11

SHEET OF

**C2**



**PONTICELLO ENTERPRISES**  
**CONSULTING ENGINEERS**

---

ALAN L. MITCHELL, P.E.  
CITY ENGINEER, CITY OF COLUSA  
1216 FORTNA AVENUE  
WOODLAND, CA 95776  
(530) 668-5883  
[alan.mitchell@ponticelloinc.com](mailto:alan.mitchell@ponticelloinc.com)